

vtech[®]

Brainy Baby[®]

User's Manual

Baby's
Creativity
Collage[™]

Age 3 months+

Right Brain[™]

Inspires Creative Thinking

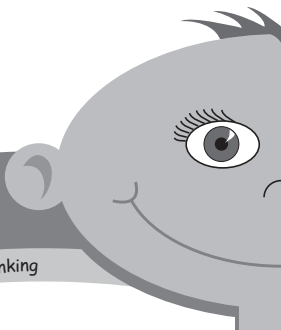

Dear Parent:

Ever notice the look on your baby's face when he learns something new? These moments are a parent's greatest reward. To encourage these moments, we have created the Brainy Baby® Left Brain™ and Right Brain™ series of toys.

Based on the award-winning Brainy Baby® video series, these toys will help develop both sides of a child's brain to give him a cognitive advantage. Right Brain™ toys focus on encouraging creative skills such as music, art, imagination, and creative thinking. Left Brain™ toys are designed to encourage cognitive thinking skills such as logic, patterns, letters & numbers, and analyzing details. Working together, this revolutionary line of toys will engage your child's whole brain, and boost a baby's intellect!

At Brainy Baby®, we know that your child's education begins at birth - and we're proud to be a part of that. After all, at VTech® and Brainy Baby®, your child's future is our inspiration!

Sincerely,

Your Friends at VTech® and The Brainy Baby® Company

To learn more about these and other Brainy Baby® products, please visit www.brainybaby.com or www.vtech.com.



Introduction

Thank you for purchasing the Brainy Baby® Baby's Creativity Collage™ learning toy.

The Brainy Baby® Baby's Creativity Collage™ is a musical activity center for babies 3 months and up. Brightly colored light-up piano keys reward curiosity with creative phrases, sounds and a variety of melodies. Each of the piano keys plays a different style of music accompanied by a fun musical phrase, encouraging baby to perceive patterns. Bright, eye-catching colors and right brain patterns encourage creative thinking.

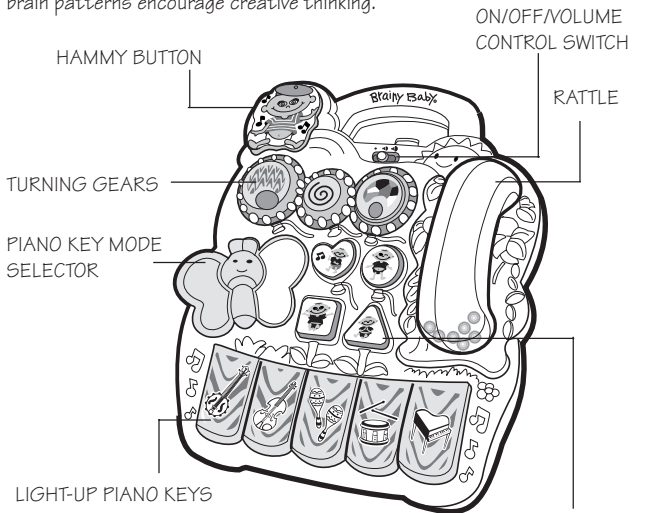

$2+2=4$

Included in This Package

- One Brainy Baby® Baby's Creativity Collage™ learning toy
- One instruction manual

WARNING: All packing materials, such as tape, plastic sheets, wire ties and tags are not part of this toy, and should be discarded for your child's safety.

Getting Started

Battery Installation

1. Make sure the unit is turned off.
2. Locate the battery cover on the back of the unit. Use a coin or screwdriver to loosen the screw.
3. Install 3 new 'AA' (UM-3/LRG) batteries following the diagram inside the battery box.
4. Replace the battery cover and tighten the screw to secure the battery cover.

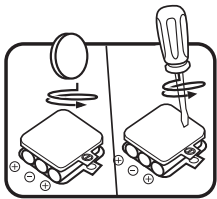

$$2+2=4$$



Battery Notice

- Install batteries correctly observing the polarity (+, -) signs to avoid leakage.
- Do not mix old and new batteries.
- Do not use batteries of different types.
- Remove exhausted or new batteries from the equipment when the unit will not be used for an extended period of time.
- Do not dispose of batteries in fire.
- Do not attempt to recharge ordinary batteries.
- The supply terminals are not to be short-circuited.
- Only batteries of the same and equivalent type as recommended are to be used.

WE DO NOT RECOMMEND THE USE OF RECHARGEABLE BATTERIES.

Product Features

1. On/Off/Volume Control Switch

To turn the unit on, slide the on/off/volume control switch to the low volume () or high volume () position. To turn the unit off, slide the on/off/volume control switch to the off () position.

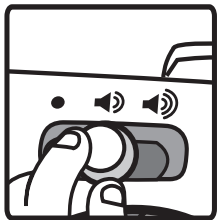

2. Automatic Shut-off

To preserve battery life, the Brainy Baby® Baby's Creativity Collage™ will automatically power-down after several seconds without input. The unit can be turned on again by pressing any button.

Activities

1. Slide the on/off/volume control switch to turn the unit on. You will hear a giggle followed by "Hello Brainy Baby. Let's play Hammy says! Hammy says clap your hands." The lights will flash with the sounds.
2. Press the shape buttons to hear a variety of phrases to encourage movement or hear a variety of melodies. The lights will flash with the sounds.
3. Press Hammy to play a fun game of Hammy says. Hammy will ask you to act out a variety of movements. The lights will flash with the sounds.

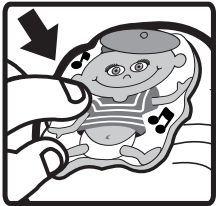
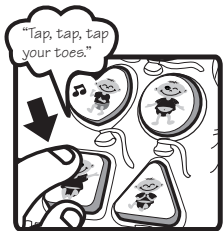
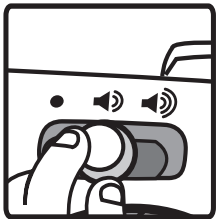

4. Turn the gears to hear silly turning sounds and fun phrases. The lights will flash with the sounds.

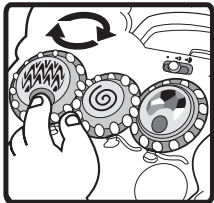

5. Press the light-up piano keys to hear individual music notes or musical phrases, short tunes and a variety of melodies depending on the mode selected. The lights will flash with the sounds.



6. Turn the butterfly wing to change the response of the piano keys. You will hear a magical sound and a fun phrase. When the butterfly wing is on the right side, press the piano keys to hear individual music notes. When the butterfly wing is on the left side, press the piano keys to hear musical phrases, instrument sounds, short tunes and a variety of melodies.

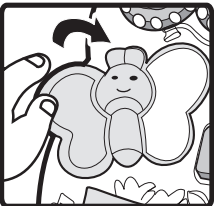

7. Grab the rattle and shake to the beat of the music. You will hear a fun music phrase when the rattle is removed and replaced on the base unit.

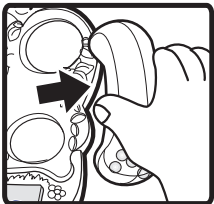

$$2+2=4$$



Melody List

1. Yellow Rose of Texas
2. Turkey in the Straw
3. Trumpet Voluntary
4. Rondo Alla Turca
5. Rockin' Robin
6. The Entertainer
7. Aloha Oe
8. Hawaiian Wedding Song
9. Memphis Blues
10. St. Louis Blues

Troubleshooting

If for some reason the program/activity stops working, please follow these steps:

1. Please turn the unit off.
2. Interrupt the power supply by removing the batteries.
3. Let the unit stand for a few minutes, then replace the batteries.
4. Turn the unit on. The unit should now be ready to play again.

If the problem persists, please call our Consumer Services Department at 1-800-521-2010 in the U.S. or 1-800-267-7377 in Canada, and a service representative will be happy to help you.

Important Note:

Creating and developing Brainy Baby® products is accompanied by a responsibility that we at VTech® take very seriously. We make every effort to ensure the accuracy of the information, which forms the value of our products. However, errors sometimes can occur. It is important for you to know that we stand behind our products and encourage you to call our Consumer Services Department at 1-800-521-2010 in the U.S., or 1-800-267-7377 in Canada, with any problems and/or suggestions that you might have. A service representative will be happy to help you.

Care and Maintenance

1. Keep the unit clean by wiping it with a slightly damp cloth.
2. Keep the unit out of direct sunlight and away from any direct heat source.
3. Remove the batteries when the unit is not in use for an extended period of time.
4. Do not drop the unit on hard surfaces and do not expose the unit to moisture or water.

Note:

This equipment has been tested and found to comply with the limits for a Class B digital device, pursuant to Part 15 of the FCC Rules. These limits are designed to provide reasonable protection against harmful interference in a residential installation. This equipment generates, uses and can radiate radio frequency energy and, if not installed and used in accordance with the instructions, may cause harmful interference to radio communications. However, there is no guarantee that interference will not occur in a particular installation. If this equipment does cause harmful interference to radio or television reception, which can be determined by turning the equipment off and on, the user is encouraged to try to correct the interference by one or more of the following measures:

- Reorient or relocate the receiving antenna
- Increase the separation between the equipment and receiver
- Connect the equipment into an outlet on a circuit different from that to which the receiver is connected
- Consult the dealer or an experienced radio/TV technician for help

THIS DEVICE COMPLIES WITH PART 15 OF THE FCC RULES. OPERATION IS SUBJECT TO THE FOLLOWING TWO CONDITIONS: (1) THIS DEVICE MAY NOT CAUSE HARMFUL INTERFERENCE, AND (2) THIS DEVICE MUST ACCEPT ANY INTERFERENCE RECEIVED, INCLUDING INTERFERENCE THAT MAY CAUSE UNDESIRABLE OPERATION.

THIS CLASS B DIGITAL APPARATUS COMPLIES WITH CANADIAN ICES-003.

CET APPAREIL NUMÉRIQUE DE LA CLASSE B EST CONFORME À LA NORME NMB-003 DU CANADA.